

## STK 1682 To Suit LKPL, NMOG and SRU Lobe Pumps

Stramek manufacture direct replacement wave-spring 'O'-Ring mounted seals to suit Alfa Laval® older generation lobe rotor LKPL, NMOG and SRU series, fitted with O.E.M. "R90®" style seals. For pumps with flush and double seals installed, see STK 1694 detailed below.

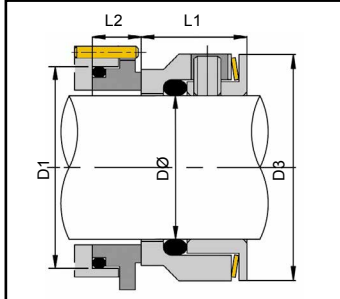

SHAFT SIZE DØ	SIZE CODE	D1	D3	L1	L2
20.00	0200	30.00	32.40	20.00	10.50
30.00	0300	41.30	44.00	21.40	11.10
35.00	0350	46.95	50.80	22.00	12.00
45.00	0450	58.26	62.40	22.90	12.60
55.00	0550	69.55	76.00	29.30	13.20
75.00	0750	92.15	99.20	31.10	14.40

## STK 1688W To Suit Alfa Laval® SR Lobe Rotor Pumps

Stramek manufacture STK 1688W 'O'-Ring mounted wave-spring seals to suit former "S.S.P.®" brand SR- series A-& G-series lobe rotor pumps.

Further sizes are available, please contact us with your requirements.

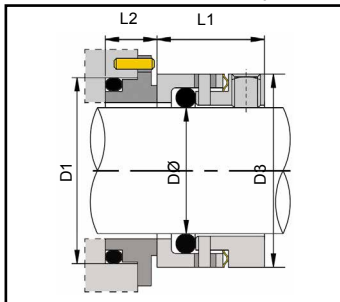

SHAFT SIZE DØ	SIZE CODE	D1	D3	L1	L2
20.00	0200	30.00	31.00	19.10	10.70
30.00	0300	41.30	41.00	19.10	10.90
35.00	0350	46.95	45.50	19.10	12.20
45.00	0450	58.26	58.20	21.10	11.60
55.00	0550	69.55	72.00	22.10	13.00
75.00	0750	92.15	96.00	25.80	14.50

## STK 1694 To Suit Alfa Laval® SR Lobe Rotor Pumps

Stramek manufacture STK 1694 'O'-Ring mounted wave-spring double seals to suit former "S.S.P.®" brand SR- series lobe rotor pumps, designed for and fitted with flushed seal chambers and double seals.

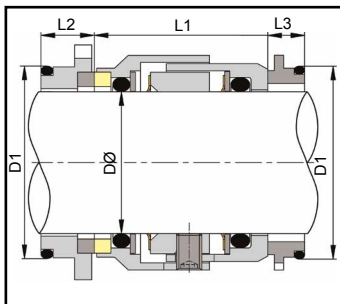

SHAFT SIZE DØ	SIZE CODE	D1	L1	L2	L3
30.00	0300	41.30	34.20	10.50	11.10
45.00	0450	58.26	37.70	11.30	11.30
55.00	0550	69.55	46.20	12.50	11.50

## STK 13M To Suit C.S.F. Inox® Pumps

Stramek manufacture 28mm STK 13M 'O'-Ring mounted conical spring seals, to suit C.S.F. Inox® AS- and CS- centrifugal pump ranges.

Stramek also offers other seals to suit C.S.F. Inox® pumps, including the STK 1605 hygienic single-spring seals to replace the O.E.M. "U" or "Y" STK externally mounted seals.

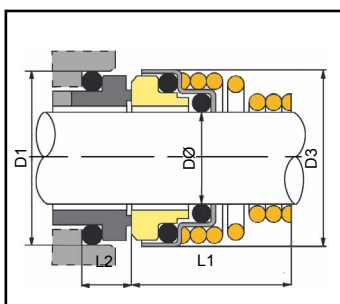

SHAFT SIZE DØ	SIZE CODE	D1	D3	L1	L2
28.00	0280	43.00	45.50	29.00	9.50